

# VIVREAU®

## Vi Tap 2 Cut Sheet

Vivreau's award-winning Vi Tap, a signature system in our portfolio, is the perfect water dispenser to suit all your needs at the touch of a button.

Project: \_\_\_\_\_

Item#: \_\_\_\_\_

Quantity: \_\_\_\_\_



### Standard features:

- Commercial designed dispense tap with LED lights and electronic touch pad
- High performance remote chiller delivering 21 gal/80L per hour of chilled still or sparkling water
- Hygienic protective shield over the internal nozzle
- Specialized nozzle with zero-splash flow
- 0.2 sub-micron activated carbon block filtration
- Drip tray with direction connection to wastewater system

### Ideal for:

VIP lounges, office pantries, staff break rooms, server beverage counters, hospitality environments or wellness and spa areas

### Average output capacity:

21 gal/80L per hour of chilled still or sparkling water

### Options & Accessories:

- Choose from a range of colors to match your decor:
- Antimicrobial films to be attached on the touchpad.
- Natural flavors available to provide a health-minded alternative to sugary sodas and expensive fruit infused service.



STILL



SPARKLING

### Specifications

Design / Type finish	Tap system / Chrome
Unit dimensions under the sink (W X H X D)	15 " X 20 " X 18 ½ " inch   38.1 X 50.8 X 46.9 cm (chiller-carbonator) 5 " (diam) X 14 " (H) inch   12.7 X 35.5 cm (chiller filter)
Unit dimensions incl. drip tray (W X H X D)	5 2/5 " X 12 5/8 " X 6 2/5 " inch   13.7 X 33 X 16.2 cm
Weight	7.4 lbs   3.3 kg (dispensing head) 73 lbs   33 kg (chiller-carbonator) 3 lbs   1.3 kg   (chiller filter)

### Millwork (Drilling templates attached on page 2)

Fits into base cabinet with the following dimensions (W X H X D)	24 " X 29 ½ " X 24 " inch   60.9 X 74.9 X 60.9 cm
Tap head clearance	Tap height: 12 5/8 " (32) cm plus additional 6", (15.2 cm) clearance for operation

**NOTE:** Tap must be mounted directly above the main system

### Electrical

Electrical Requirement	(1) 20amp electrical circuit (NEMA 5-20R) 120V, 60Hz (11 amps)
------------------------	--

### CO2

CO2 (customer supplied)	If connecting to a bulk or existing CO2 system, a CO2 line terminating at a ¼" barbed shutoff valve must be available within 40" of the System installation site, 100psi minimum pressure.
-------------------------	--

### Plumbing

Water connection	1 potable ½" cold water supply terminating in a ½" ball valve with a ½" female pipe thread
Drip tray drain	Customer needs to supply a rigid vertical pipe that drains to a properly trapped drain according to local codes. The vertical pipe for the drip tray drain must be located inside the installation cabinet and must be at least 1 ¼" ID.
Minimum water pressure	50 PSI
Minimum water flow	80 gallons, 302.8 L per hour

### NOTE:

- Any incoming water temperature above 60°F (15.5°C) will severely compromise the ability for the system to maintain a cold water supply.
- Ensure that there is sufficient room for a 12" (30.4 cm) long fitting tube connected to the shut-off valve. Top of waste up stand should be a maximum of 24" (60.9 cm) from the base of the unit.

# Vi Tap Standard View for Worktop Cutout

There are four holes to be drilled.

**2x** mounting holes, **1x** drain hole, **1x** tap hole

**THIS DRAWING IS NOT TO SCALE**

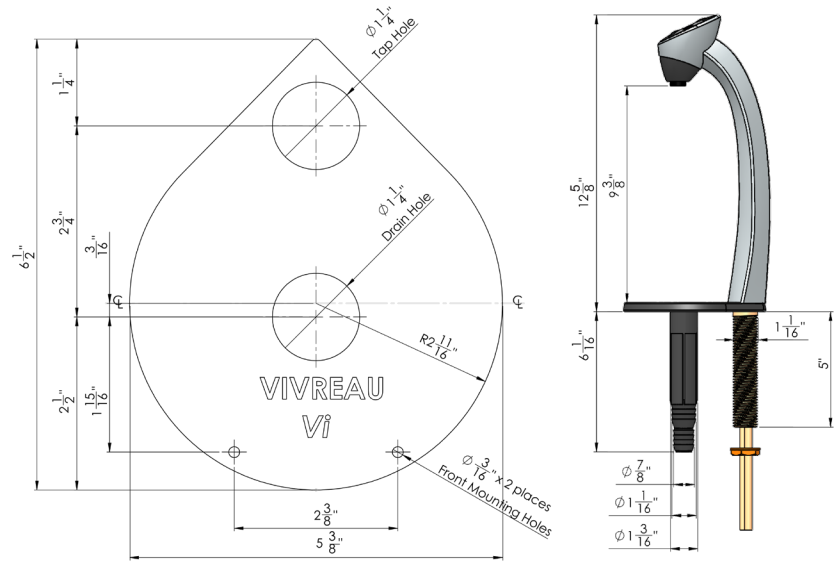

## Approved Methods of Cabinet Ventilation

The cabinet may be ventilated in several different ways to prevent excessive heat build-up. the methods shown all take advantage of natural circulation by placing two grilles or cut-outs; one near the base and the other at the top of the enclosure.

Please note, all vents must open to fresh air in a free and unobstructed area and 24 square inches of opening is required for each of the top and bottom vents (48 square inches in total).

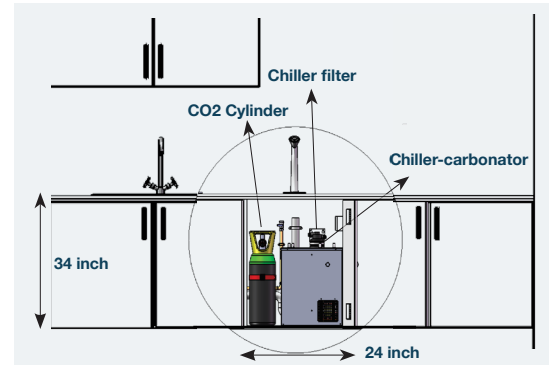

### 4) Top Ventilation

Countertop cutout can be used as a top ventilation option.

### 1) Front Ventilation

Showing Ventilation grills cut in a standard door panel.

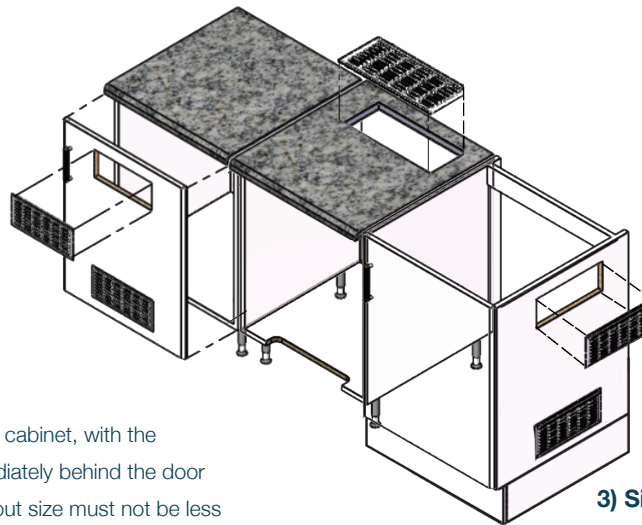

### 2) Base Cutout

Ventilation can be made to the base of the cabinet, with the removal of a narrow section of floor, immediately behind the door and trim with roll edging strip. Typical cut-out size must not be less than 12.0" wide x 2" deep (24 sq inch).

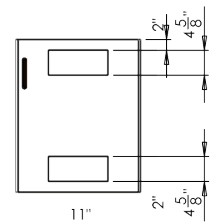

Cut-out detail for the available 12" (30.48 cm) VIVREAU grill, shown in a 23.5" (59.69 cm) [24"] wide door

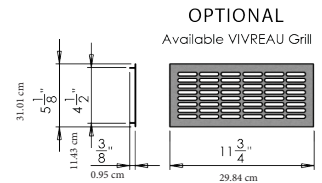

### 3) Side Ventilation

Ventilation grilles cut in the side of a standard cabinet. The grilles may be fitted on either side.

**DOES NOT OPEN INTO AN ENCLOSED CABINET**

### Consultant specification:

Vivreau Water Dispensing System, single tap, fully integrated undercounted, micro-filtered, chilled still & sparkling drinking water, touch control dispenser, chiller-carbonator, water filter, Mavea descaling filter, zero splash, anti-flood detection, removeable dispense nozzle, component format, ETL, NSF (24 " X 29 1/2 " X 24 " inch cabinet required for installation, for indoor use only)



All Vivreau products are Intertek and NSF Certified.